



1862  2012
GUSTAVUS ADOLPHUS COLLEGE
150 AND COUNTING

GUSTAVUS 
GUSTAVUS ADOLPHUS COLLEGE

150 YEARS AND COUNTING

WARREN & DONNA BECK ACADEMIC HALL

BECK ACADEMIC HALL

Designed for our aspirations and built for our needs, Beck Academic Hall delivers on its original design outcomes to:

- Contribute to excellence in the teaching and learning experience
- Provide an attractive and beneficial asset to the campus
- Promote sensitive stewardship



EXCELLENCE IN TEACHING AND LEARNING

The Warren & Donna Beck Academic Hall brings together the academic departments of Communication Studies, Economics and Management, History, Psychology, and Sociology and Anthropology.

Along with state-of-the-art classroom tools and technologies, Beck Academic Hall features psychology labs designed to help foster student-faculty collaboration and interdisciplinary research, a digital arts lab, studio space for GAC-TV and KGSM radio, a large team room for the college's nationally ranked forensics program, and dedicated space for the Neuroscience Program.

Another unique aspect of the building is the amount of space available for students to gather and collaborate outside the classroom. In addition to the building's large atrium, each academic department has a student interaction room where students can study, hold meetings, and socialize before and after classes.



ALUMNI AND FACULTY ARTWORK

FIRST FLOOR

Bruce McClain

Professor Emeritus | *Sky Split* | Acrylic on canvas
Clouds Islands II | Acrylic on canvas

Betsy Byers

Gustavus Faculty | *Submerge* | Oil on canvas

SECOND FLOOR

Lois Peterson

Gustavus Faculty | *Conversation* | Oil stick drawing on board

Betsy Byers

Gustavus Faculty | *Permeate* | Oil on canvas

Susan M. Davies-Polzine

Class of 1982 | *Evensong II* | Oil on canvas

Priscilla Briggs

Gustavus Faculty | *Red and Gold* | Lightjet print

Nicole Hoiland

Gustavus Faculty | *Kites I* | Stoneware and slip

THIRD FLOOR

Megan McCready

Class of 2002 | *Easy Does It* | Baltic birch panel, dark walnut stain, and easy cheese

Anthony Marchetti

Class of 2001 | *Duplex, Tijuana* | Archival inkjet print

Lisa Manthe

Class of 1987 | *High Heels* | Acrylic on canvas

Kristen Lowe

Gustavus Faculty | *Forming Nest I, II, & III* | Charcoal on paper

Sara Blair

Class of 2000 | *Gray Area* | Cotton thread and Bible pages

Chris Price

Class of 2002 | *Mystic Burrow* | Oil on canvas

Todd Heimdahl

Class of 1964 | *Wind Cave Bison* | Watercolor on paper



ASSET TO CAMPUS

Beck Academic Hall is designed to encourage collaboration and community. According to the faculty liaison for the Beck Academic Hall project, Professor and Chair of Psychology Dr. Jennifer Ackil, “Beck Academic Hall really raises the bar when it comes to the opportunities students will be afforded both inside and outside the classroom. This will not be a 9 to 5 building. We think this building will have a vibrancy to it that will draw students into ongoing intellectual conversations, research activity, and creative pursuits with each other and with faculty.”

In addition, Beck Academic Hall is visually connected to the rest of the campus with architectural elements and details familiar to other campus buildings: vertical proportions, framed openings, and the use of the timeless, buff-colored Kasota stone.

The Warren & Donna Beck Academic Hall was a dream for many years. The Commission Gustavus 150 process turned that dream of a new academic building, the first on the campus in twenty years, into a recommendation. That recommendation became a reality in the fall of 2011 with the opening and dedication of Beck Academic Hall.

Sustainable design strategies offer value and efficiency and promote a commitment to stewardship. Using LEED as a guideline, sustainability and energy efficient design were priorities from the project’s beginning. It is modeled to save 44 percent more energy and 30 percent more water than typical code requires.

Beck Academic Hall exceeds the State of Minnesota Sustainable Building 2030 targets.

Students and faculty alike are giving Beck Academic Hall an enthusiastic “two thumbs up”. You are invited to explore the building and see for yourself what all the excitement is about.



Gustavus is at a time in its history when the steps taken in the next few years will strengthen the foundation and the future of the College. We are truly impressed with the commitment of the administration, faculty, staff, and trustees. The future of Gustavus is indeed in good hands. We feel called at this time in our lives and the life of Gustavus to make this transformational gift.

- Warren '67 & Donna '66 Beck

CLASSROOM ROOM 315

A small camera mounted in ceiling provides the capability to record lectures and speeches.

PERCEPTION & ATTENTION LAB ROOM 316

Focused on the study of visual and auditory perception and attention, one room allows students to present and collect precise acoustic energy within its soundproof isolation booth while the other room is equipped with an eye-tracker used to follow and record the movement of an individual's eyes.

CLASSROOMS ROOMS 217 & 317

Contain three interactive projectors, similar to a smart board, allowing multiple presenters to modify an image while it is projected on the wall.

OFFICES FOR COMMUNICATION STUDIES DEPARTMENT ROOMS 329-347

Nine faculty offices, office and student support areas, and a department student interaction room

OFFICES FOR HISTORY DEPARTMENT ROOMS 349-371

Nine faculty offices, office and student support areas, and a department student interaction room



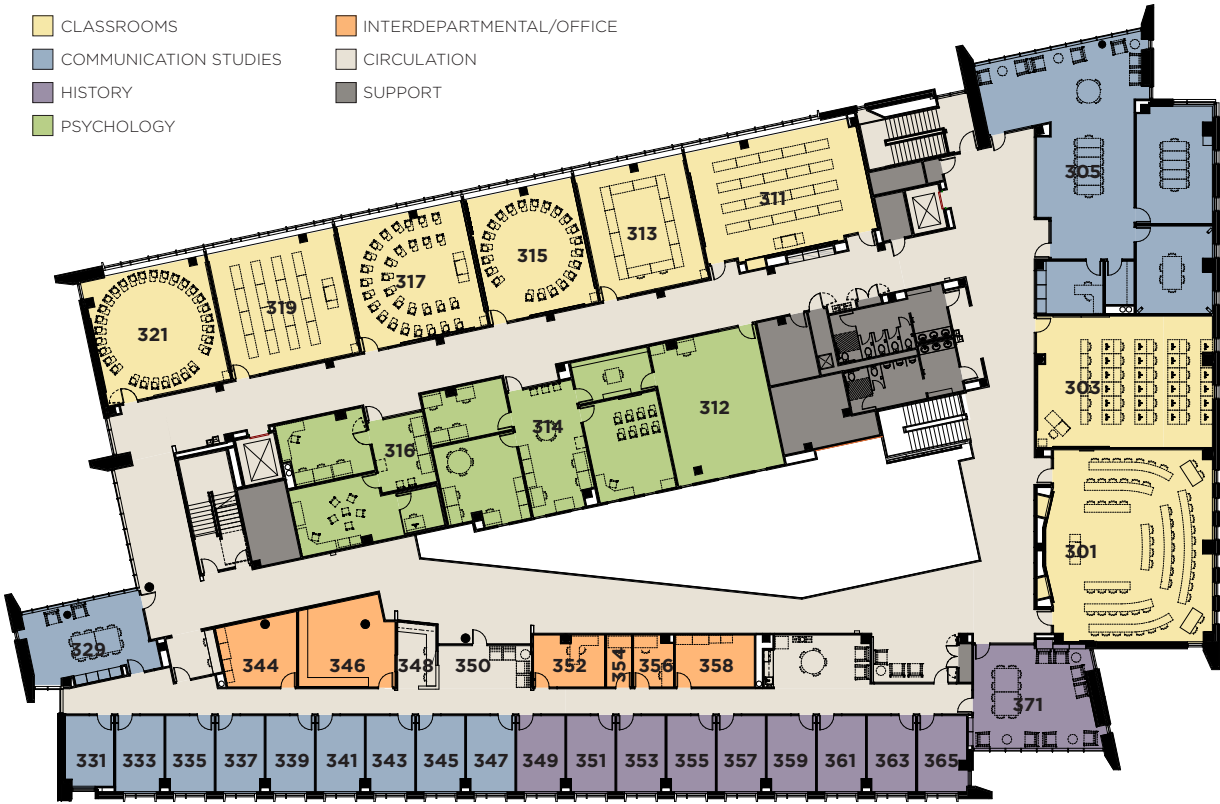

THIRD FLOOR FEATURES

FORENSICS TEAM ROOM
ROOM 305

Provides the nationally recognized forensics program a dedicated practice space.

PERSONALITY & CLINICAL LAB
ROOM 312

This lab contains state of the art visual and auditory presentation equipment necessary to invoke various states of relaxation as a means of exploring various questions about the mind-body connection.

SOCIAL & COGNITION LAB
ROOM 314

An example of how Beck Hall intentionally combines different research areas around a shared common room to generate an exchange of ideas and knowledge among students studying different topics.

Warren and Donna Beck have been active in leadership roles at Gustavus for nearly 30 years. Warren has served as a member of the Board of Trustees three different times, including stints from 1986 to 93, 1996 to 2002, and 2007 to the present. He also served twice as chair of the Board, and his tireless project management efforts following the 1998 tornado that devastated campus were recognized in 1999 with the Greater Gustavus Award. Most recently he was chair of Commission Gustavus 150. Donna is a founding member of Gustavus Library Associates. She has served as chair of the GLA Board as well as in leadership roles for A Royal Affair.

Warren is a 1967 Gustavus graduate and has served as president of Gabbert & Beck, Inc., since 1972. In addition to managing retail commercial properties in the Twin Cities, including the Galleria shopping center in Edina, he has served as president of Galleria Hotel LLC since 2006.

Donna is a 1966 graduate of the College. In addition to her involvement at Gustavus, she serves on the board of trustees of the Minnesota Landscape Arboretum and has been involved with Children's Hospital Clinics of Minneapolis, WAMSO-Minnesota Orchestra Volunteer Association, Junior League of Minneapolis, 4-H, the Girl Scouts, and Plymouth Congregational Church. She also has a special interest in showing American Saddlebred horses and Hackney ponies.

Among their many involvements and interests, Warren and Donna cherish most the time spent with their three children, Paula, Amy '93, and Peter, as well as four grandchildren.

Warren and Donna Beck represent all that is good about being Gusties.

BECK ACADEMIC HALL TIMELINE

SPRING OF 2008

Gustavus hired BWBR Architects out of St. Paul, Minn., to lead the creation of the design for a new academic building

JANUARY 2010

Gustavus Board of Trustees voted unanimously to move forward with three major building projects: a new 125,000 square foot academic building, a mall extending west from Christ Chapel, and to renovate the A.H. Anderson Social Science Building

APRIL 2010

Groundbreaking held for the new academic building and Kraus-Anderson announced as the general contractor

JUNE 2011

The Board of Trustees approved naming the building the Warren & Donna Beck Academic Hall

SEPTEMBER 2011

Beck Academic Hall opened for classes

OCTOBER 2011

Building Dedication

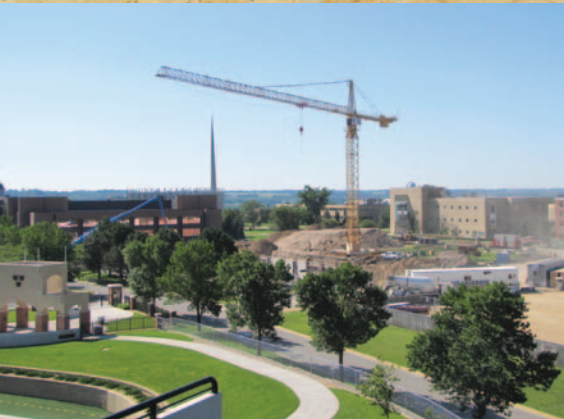

BUILDING AREA SQUARE FOOTAGE

COMMUNICATION STUDIES

7,169 square feet

ECONOMICS & MANAGEMENT

3,452 square feet

HISTORY

2,109 square feet

PSYCHOLOGY

14,750 square feet

SOCIOLOGY & ANTHROPOLOGY

1,736 square feet

CAMPUS/CLASSROOMS

26,002 square feet

UNASSIGNED (BASEMENT)

18,628 square feet

SUPPORT

21,629 square feet

CIRCULATION

30,025 square feet

TOTAL AREA

125,500 square feet



LEADERSHIP IN ENERGY AND ENVIRONMENTAL DESIGN (LEED) STRATEGIES

Environmental sustainability was integrated into all aspects of the design and construction of Beck Academic Hall, from the shape of the building to allow for ample day lighting in all spaces to the high-efficiency condensing boilers for heating.

An integral part of the LEED certification of Beck Hall is a comprehensive set of solar panels, both photovoltaic (electricity) as well as solar thermal (hot water). The complete installation of the solar system was provided by a generous gift from a parent whose three sons attended Gustavus.

To educate visitors and building occupants on the sustainability aspects of the building, including real-time energy consumption and production, a monitor "dashboard" is located in the lobby

PSYCHOPHYSIOLOGY TEACHING LAB ROOM 207

The equipment allows students to observe and record measures of muscle activation, heart activity, blood pressure, arousal, brain waves, respiration, and a variety of other measures. Each recording station is paired with a stimulus presentation station to design and control experiments that test the impact of psychologically meaningful visual and auditory stimuli on biological measures. The new fNIR brain imaging system records changes in blood flow in the frontal cortex, providing state-of-the-art research in cognitive and social neuroscience.

BRAIN AND BEHAVIOR TEACHING LAB ROOM 212

NEUROSCIENCE TEACHING LAB ROOMS 214 & 218

NEUROPHYSIOLOGY LAB ROOM 216

Collectively these lab spaces allow students to learn modern cellular, systems, and behavioral techniques. The facilities include electrophysiology workstations to measure the electrical signaling behavior of neural tissue and an observational area with video acquisition software to record animals participating in behavioral neuroscience experiments.

OFFICES FOR SOCIOLOGY AND ANTHROPOLOGY DEPARTMENT ROOMS 229-244

Six faculty offices, office and student support areas, and a department student interaction room

OFFICES FOR PSYCHOLOGY DEPARTMENT ROOMS 243-271

Twelve faculty offices, office and student support areas, and a department student interaction room



- CLASSROOMS
- PSYCHOLOGY
- SOCIOLOGY & ANTHROPOLOGY
- INTERDEPARTMENTAL/OFFICE
- CIRCULATION
- SUPPORT

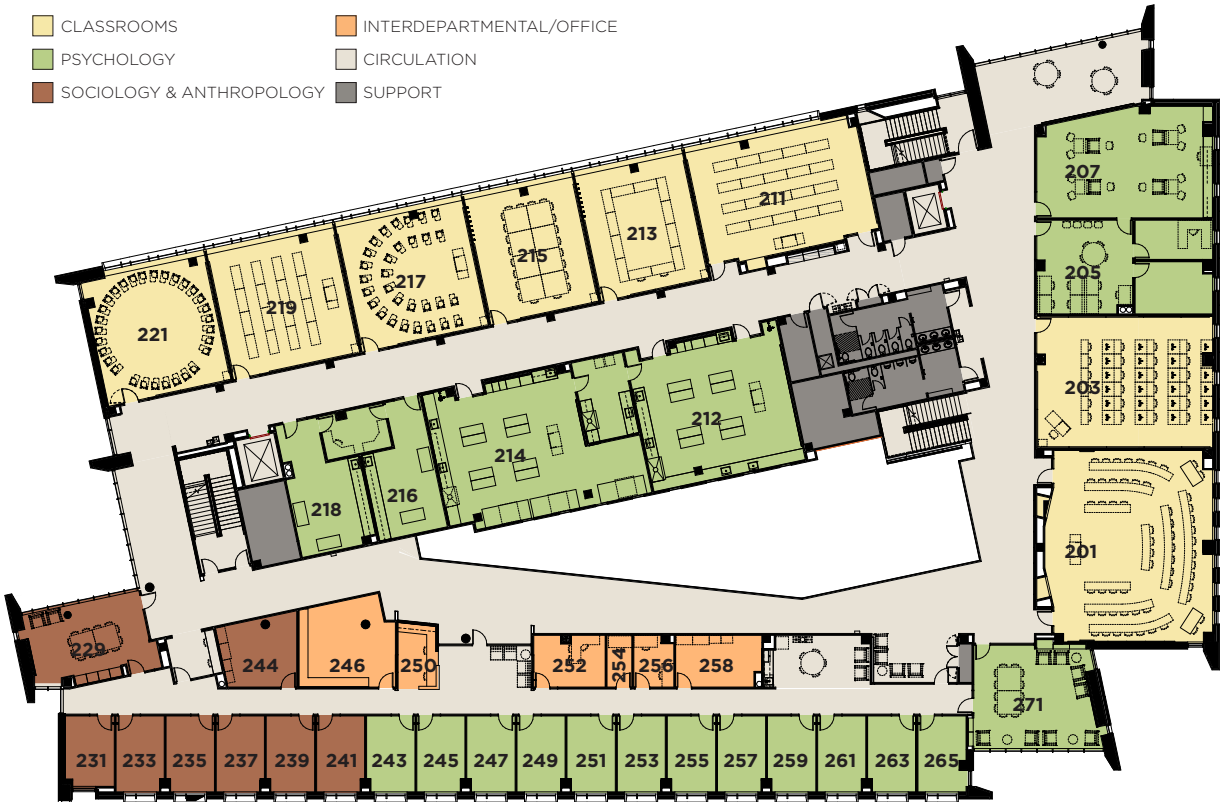

SECOND FLOOR FEATURES

CLASSROOM
ROOM 201

All faculty teaching in Beck Hall will work on laptops, which communicate wirelessly with any projector in the building including rooms such as Classroom 201 with two LCD projectors to enhance teaching options.

CLASSROOM
ROOM 203

Computer lab for laptop computers

SOCIAL NEUROSCIENCE LABS
ROOM 205

Features a new 128 electrode array EEG recording station to improve students ability to map brain activity across the entire cortex and an advanced digital video recording lab to record changes in facial expression and automatically register changes in the intensity and valence of a research participant's emotional state.



SITE

- Minimal site disturbance
- Stormwater management
- Maximized open space
- Reduction of shaded hardscape
- Cool white roof
- Bicycle storage
- Reduced light pollution

WATER

- 30% water use reduction
- Water-efficient landscaping
- Use of native plants

ENERGY & ATMOSPHERE

- Enhanced commissioning of systems
- Measurement/verification of systems
- 44% energy savings
- Refrigerant management
- On-site renewable energy
- Photovoltaic panels

MATERIALS & RESOURCES

- Occupant recycling
- 20% or more regional materials
- 75% construction waste
- 10% recycled content materials
- FSC certified wood

INDOOR ENVIRONMENT QUALITY/
THERMAL COMFORT

- Low-emitting materials
- Occupant control of lighting
- Construction IAQ management
- Occupant control of mechanical
- Isolation of chemical sources
- Extensive daylighting

LEED Goal: Gold Certification or higher





FIRST FLOOR FEATURES

ATRIUM

This beautiful and flexible space can be used for anything from student study space to larger gatherings or receptions.

KENDALL CENTER FOR ENGAGED LEARNING ROOM 103

Office space for the John S. Kendall Center for Engaged Learning, which supports faculty in achieving their potential as teachers and scholars.

SOCIAL INTERACTION LAB ROOM 105

State-of-the-art cameras and software allow for observing, recording, measuring, and analyzing various levels of social interaction.

THE CENTER FOR DEVELOPMENTAL SCIENCE (CDS) ROOM 109

The parent-child interaction room includes cameras, wireless microphones, and a one-way observation window. Student researchers record time-synced audiovisual information as parents and

children participate in experiments.

The infant testing room includes three LCD monitors arranged as an 86" display. A camera located behind the display allows student researchers to use an infant's visual attention as a measure of their cognitive processes.

THE DIGITAL ARTS LAB ROOM 112 (COMPLETE NOVEMBER 2011)

Seventeen high-powered editing stations in the classroom, plus two designated editing suites for uninterrupted individual work with a state-of-the-art media-management intranet for fast and secure video editing, digital photography, Web design, and computer-aided drafting.

THE DIGITAL ARTS STUDIO ROOM 116

A full professional-grade production studio with live multi-camera recording for professional-style live-to-tape productions. "Behind the camera" education in areas such as lighting and special effects technology link practical, hands-on learning to aesthetic theory and media literacy.

KGSM STUDIO ROOM 118

New studio and control room for professional-style radio production including the capability for webcasting, live in-studio music performances, multiple DJs/interviewees.

OFFICES OF ECONOMICS AND MANAGEMENT DEPARTMENT ROOMS 133-165

Eighteen faculty offices, office and student support areas, and a department student interaction room

STUDENT INTERACTION ROOM ROOM 144

Each academic department has a corresponding student interaction room to accommodate informal student discussions and studying.

